

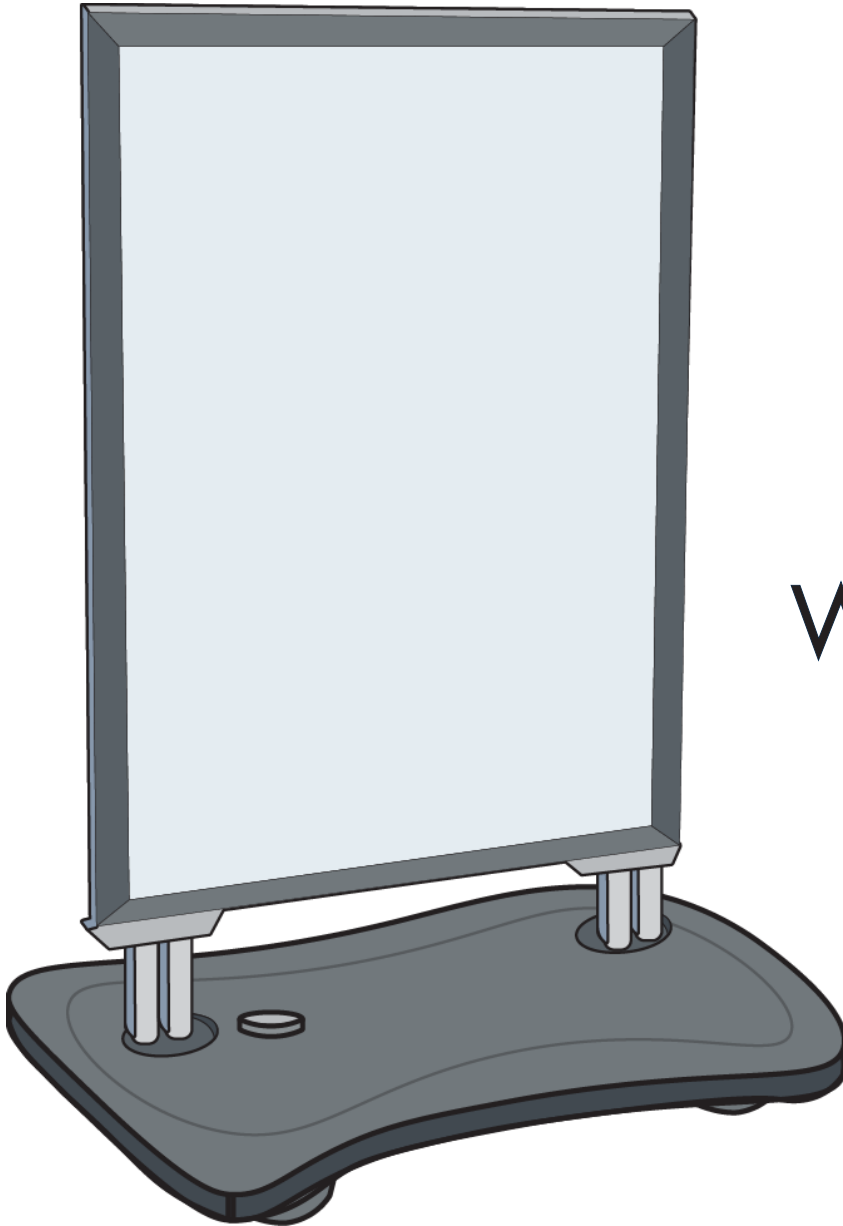

DISPLAYS2GO
CONNECTING PEOPLE & BRANDS WITH THE WORLD



**OUTDOOR
SIDEWALK
SIGN WITH
WATER-FILLED
BASE**

User Manual

SKU: PSSS3040BK

PARTS LIST



Scan QR code
to visit product
page

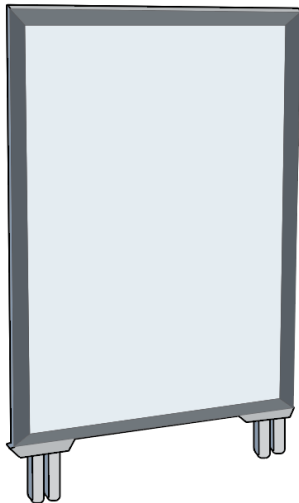

PART

QUANTITY

| | |
|-------------------------|---|
| A: Water-Fill Base..... | 1 |
| B: Poster Frame..... | 1 |
| C: Wingnut Screw..... | 4 |

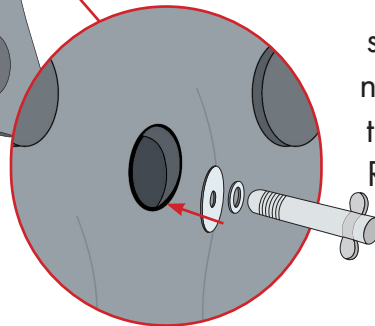
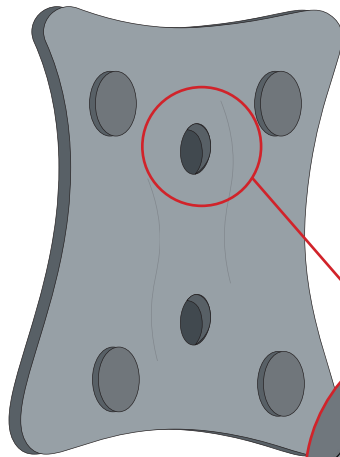
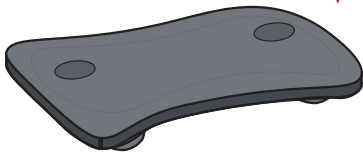
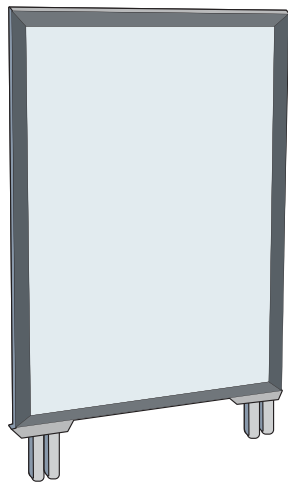
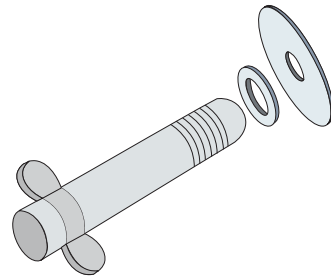
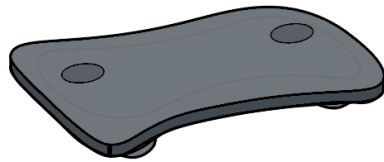

1. Insert signage frame into base.

2. Flip unit onto its side, then insert wingnut screw with washer and nut through the holes on the bottom of the base. Repeat for each screw.

If you have any questions regarding our products, please visit us at www.displays2go.com or contact Displays2go customer service at 844-221-3388.

3. Snap frame open and remove the poster cover from the frame.

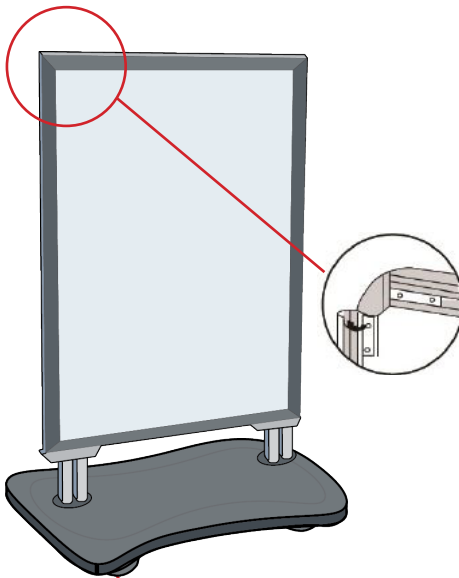

4. Insert desired poster into frame, then replace the poster cover. Snap the frame closed.

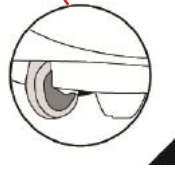

5. Move unit to desired location, then fill base with either water or sand.

NOTE: Empty base before storing or moving again.

Enjoy your new sidewalk sign!

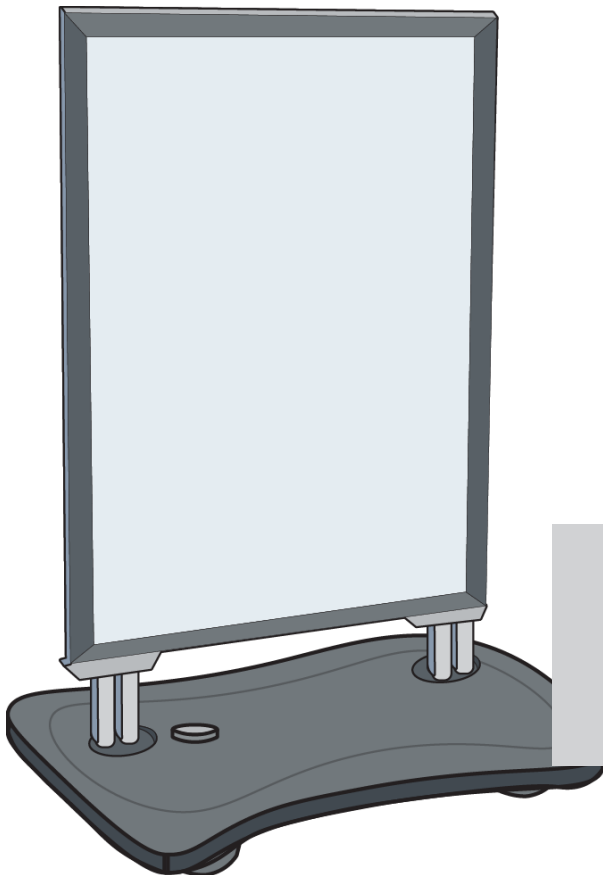

CONTACT INFORMATION:

www.displays2go.com

PHONE: 844-221-3388